

NORTH MAIN STREET

COMPILED PLAN OF THE  
COHASSET CENTRAL CEMETERY  
FROM  
NORTH MAIN ST. TO SEASIDE AVE.  
COHASSET, MASS.

Scale 1"=20'

Mar. 9, 1961

Lewis W. Perkins & Son, Eng'rs., Hingham Mass.

Note: By agreement with the Hingham Cemetery Commission, the plan of the cemetery is shown as of 1961. The plan is based on the original plan of 1852, as amended by the Hingham Cemetery Commission, and the plan of 1920, as amended by the Hingham Cemetery Commission.

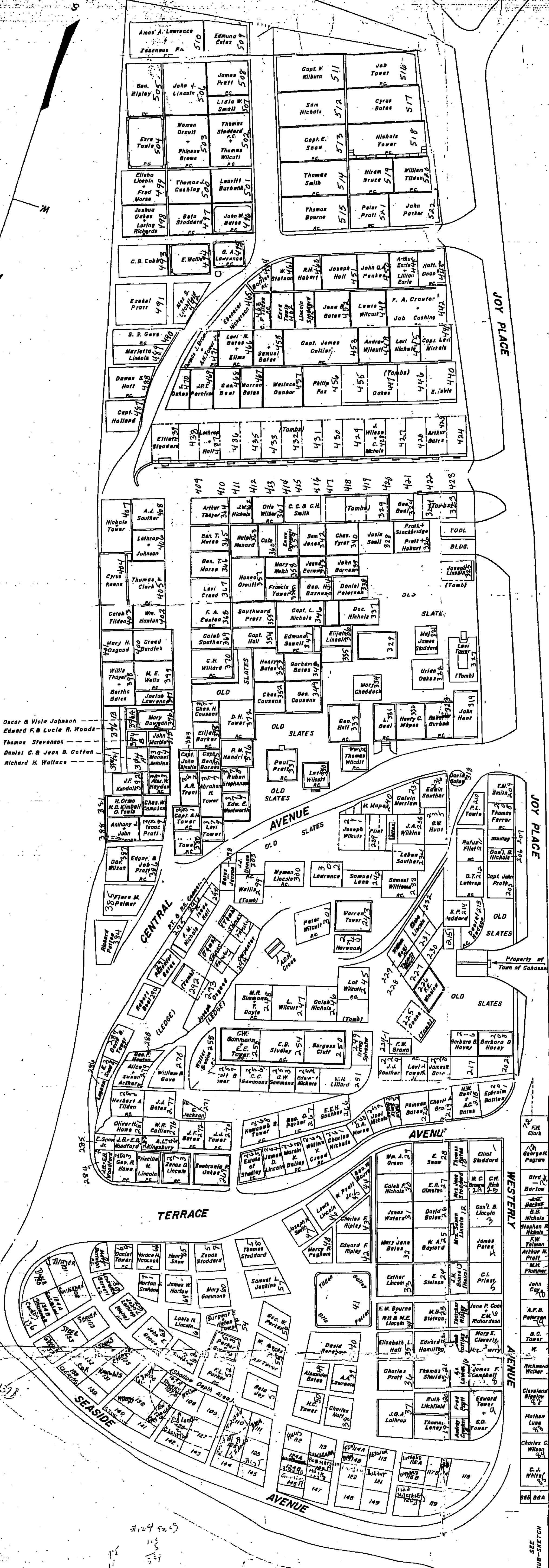

SEASIDE AVENUE SECTION

LOT	Name	LOT	Name
101	S. Thayer	126 A	M. BRUNS BROWN
		126 B	JOSAPH V. & IRENEYI FANEY
102	Willard J. Tuckerman	127	
103	Albert H. & Edna H. Seaver	128 A	EDWARD B. LONG
		128 B	ROBERT CRADDOCK
104	Francis E. Jenks	129	EVERETT W. GARDNER
105	Charles E. & Barbara H. Thayer	130	Carleton M. & Marion H. Woods
106	George W. & Helen F. W. Smith	131	Robert C. & Virginia W. Knowles
107 A	LAMARCO M. & ANS R. THOMAS	132	
		133	Edward & Jane Steel
108	E. A. Watson	134 A	Carl B. Ferguson
109		134 B	Edgar H. Plummer
110	TIMOTHY A. HONIGAN	135	Kenneth Doble
111	John & Elizabeth Dawn	136	W. M. COOKES
112	Alex & Roberta E. Hills	137 A	MALBOM & SYLVIA J. GREEN
113	Spurgeon H. & Mary E. Cunningham	138	ROBERT CLEAVES JR
114 A	Clorence M. & Elizabeth T. Flint	139	
114 B	Elmer H. & Ruth A. Pratt	140	
115	Kenneth D. & Helen L. Ketchum	141	
116 A	Emory W. Lathrop	142	
116 B	Rene & Jane Onwood	143	
117 A	Richard Hazleton Rice	144	
117 B	Wilegarde Claire (Bridgely) Rice	145	
118	Alonzo Hazleton Rice	146 A	GULBERT CHAPMAN
119	Gladys May (James) Rice	147	
120		148	
121	H. KINGSLEY & DOROTHY H. DURANT	149	
122	JOHN H. LINSLEY	150	
123 A	HOWARD S. & MINER R. RAY		
123 B	Geo. J. Conroy		
124 A	Anthony & Katharine Whitemore		
124 B	RICHARDSON WHITE		
125	ALFRED R. ROY T. R.		

SMALL LOT SECTION

Lot	Name	Lot	Name
85 A	Thomas M. & Ruth D. James	91	Lindsay D. Allen
85 B	Harry O. & Caroline B. Williams	92	JAMES T. M'CHARTHY - REBEKAH BROWN
86 C	Zula Knobe	93	
87	H. K. & Florence A. Barlow	94	
88 A	Bernice C. ...	95	Minor A. & Eunice I. Browne
88 B	...	96	Arthur C. & Alice S. Neale
89	...	97	David & Jean Chalmers Jansz
90	...	98	
99	...	159	CATHERINE HUMPHREY
100	...	160	RALPH D. KNAPP
101	...	161	...
102	...	162	...
103	...	163	...
104	...	164	...
105	...	165	...

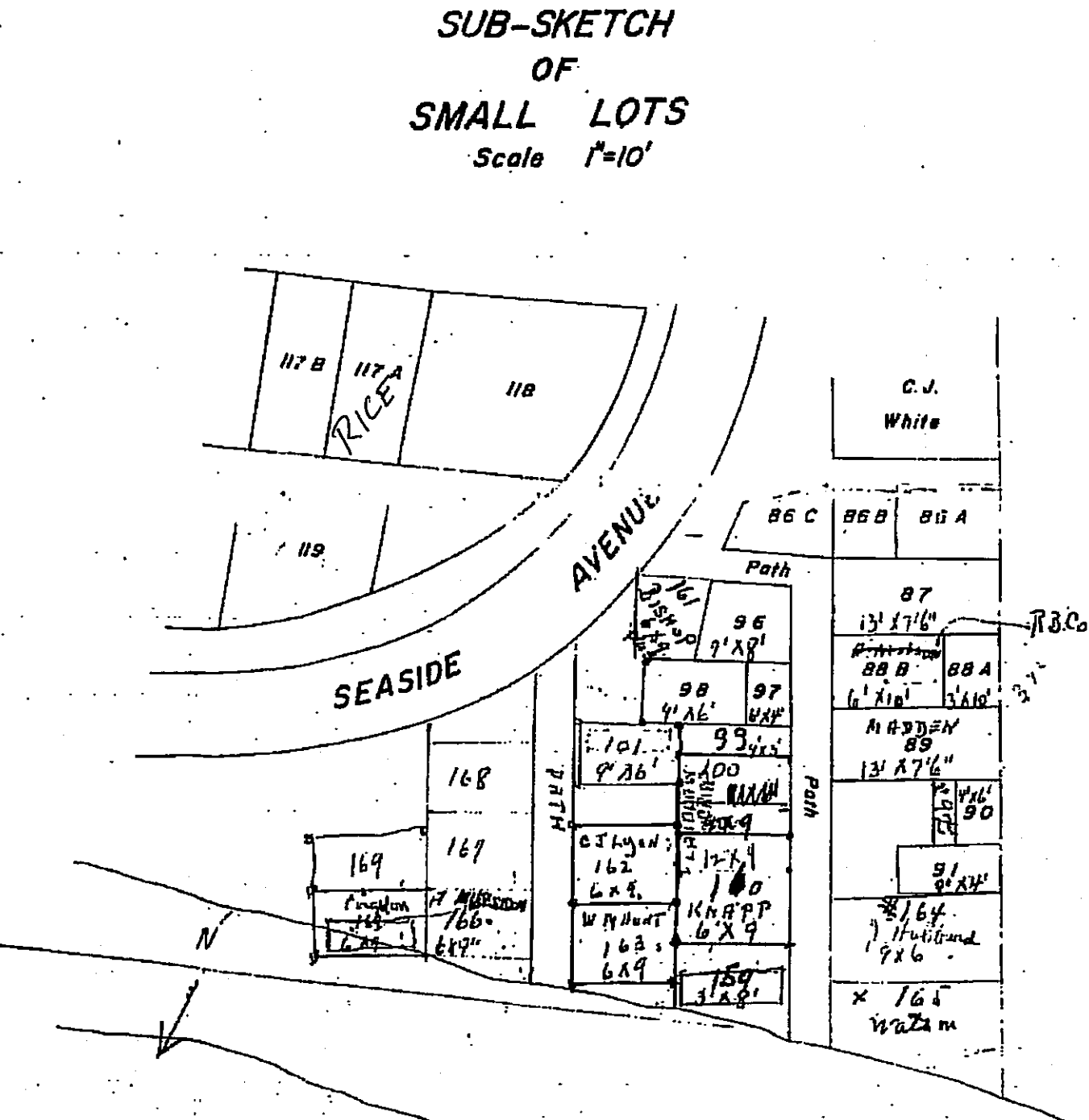

Handwritten notes and signatures on the right margin, including 'P. L. T. ...' and '1961-1962'.