

119

AVENUE

SEASIDE

Montague

86 C
KNODE

86 B
WILLIAMS

86 A
JAMES

Path

BARTOW
87
(13 x 1/2)

161
BISHOP
91

BROWNE
96
(7 x 8)

COULTER
88 B

88 A
KOOPMAN

BATES
97
(6 x 4)

D. TOWER
98
(6 x 9)

NISOLA
97
(6 x 4)

MADDEN
89

173

HABERTY

167

RENICK
Remick
(9 x 12)

101
CALDERWOOD
(6 x 9)

99
BURRINGHAM

100

LADLAW
(7 x 9)
13 x 9

Path

169 B

DEAN

171
LITTLEHALL

GIBSON
93
Tebbetts

RESATHUN
92
90
(4 x 6)

MCC

169 A

COWDON

166

NILSSON
(6 x 9)

162
NORRIS
(6 x 9)

160
KNAPP
(6 x 9)

DIBENNY
94

ALLEN
91
(9 x 4)

164
HUBBARD

163
HUNT
(6 x 9)

159
HUMPHREY
(3 x 9)

165
WATSON

8/22/1

Important

Postage
Set
Beach
at 1/10

LITTLE HARBOR

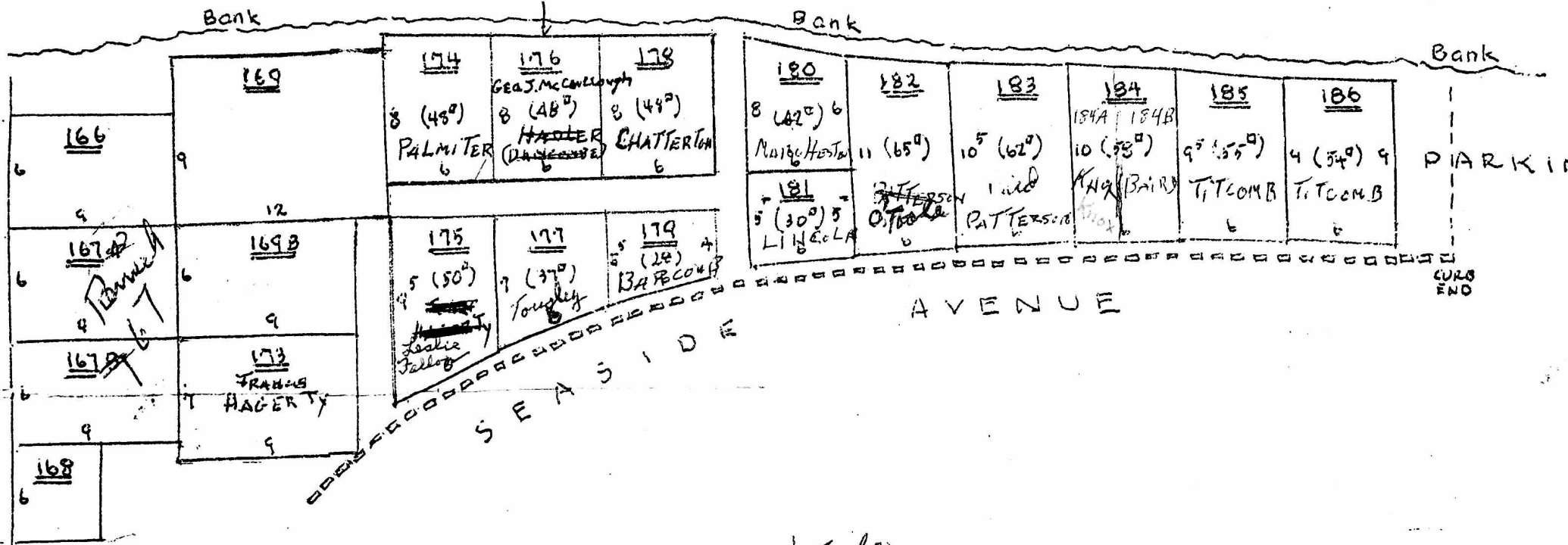

- * 174 PALMITER
Leslie Fallon
- 175 John & Elizabeth HAGERTY
- 176 ~~HAGERTY~~
- 177 TOWSELEY
- 178 MRS FRANK B. CHATTERTON
- 179 WAYNE BARCOMB
- 180 Manchester, Eli
- 181 Edwin C. & Katherine M. Lincoln

- 182 ~~PATTERSON~~ O'Toole
- 183 PATTERSON
- 184 A ROBERT J. KNOX
- 184 B WILLIAM + PATRICIA BAIRD
- 185 CLEMENT
- 186 MARY R. TITCOMB

SUB SECTION

NORTHWEST (Water) SIDE - SEASIDE AVE

Scale 1/8" = 1 Foot

AEY